

Logementet i Kviberg

65 kvm













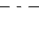

3 rum och kök

Hus: 1

Lgh: 13-1103, 13-1203, 13-1303, 13-1403

Upplåtelseform: Bostadsrätt

Våning: 1, 2, 3, 4

-  Diskmaskin
-  Häll med inbyggnadsugn
-  Frys
-  Kylskåp
-  Förberett för mikrovågsugn
-  Överskåp
-  Duschvägg
-  Kombimaskin
-  Linnedel
-  Städskåp
-  Elcentral
-  Radiator
-  Hatthylla
-  TH Takhöjd vid inklädnad/lokal försänkning, anges i meter
-  BH Bröstningshöjd, anges i meter
-  SKJD Skjutdörsgarderob

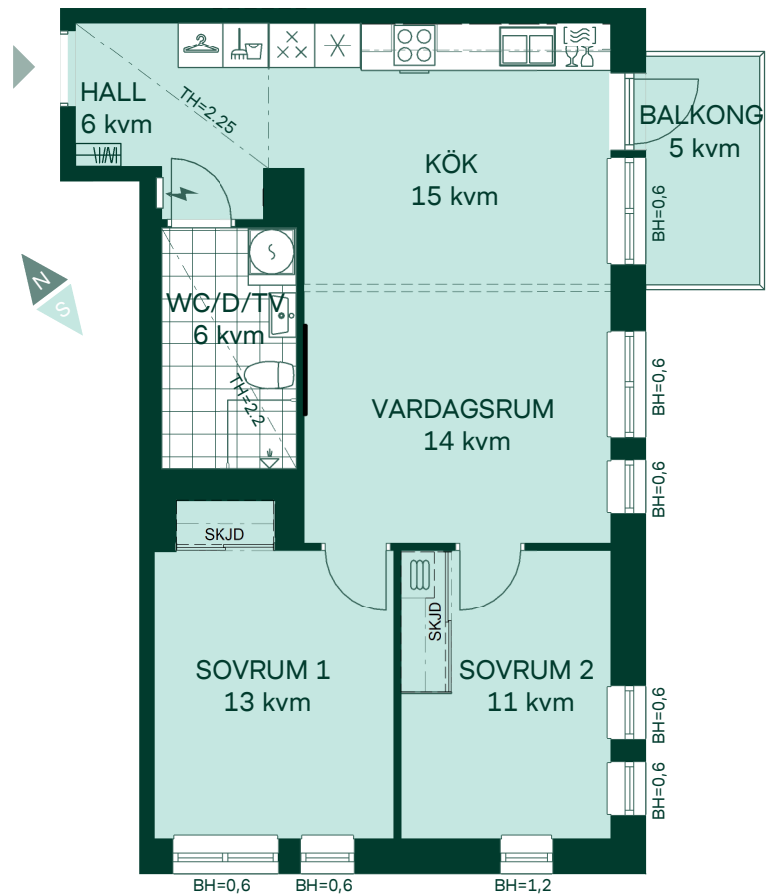

Takhöjd 2,5m om inget annat anges.
 Mått anges i meter.
 Kvadratmeter är cirka.
 All inredning monteras enligt planritning.

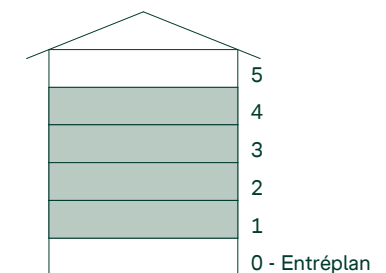
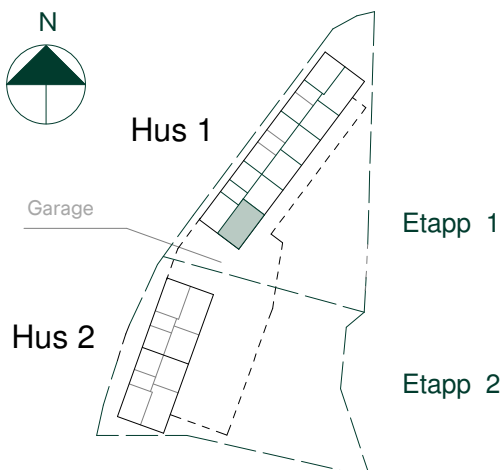

SKALA 1:100



Reservation för eventuella ändringar och ytavvikelser.
 Datum: 2021-05-18