

Logementet i Kviberg

43 kvm











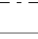

2 rum och kök

Hus: 2

Lgh: 21-1001

Upplåtelseform: Bostadsrätt

Våning: 0 - Entréplan

-  Diskmaskin
-  Häll med inbyggnadsugn
-  Kylskåp och frys
-  Förberett för mikrovågsugn
-  Överskåp
-  Duschvägg
-  Kombimaskin
-  Klädförvaring
-  Linneskåp
-  Städsåp
-  Elcentral
-  Radiator
-  Hatthylla
- TH** Takhöjd vid inklädnad/lokal försänkning, anges i meter
- BH** Bröstningshöjd, anges i meter
- SKJD** Skjutdörsgarderob

Takhöjd 2,5m om inget annat anges.
Mått anges i meter.
Kvadratmeter är cirka.
All inredning monteras enligt planritning.

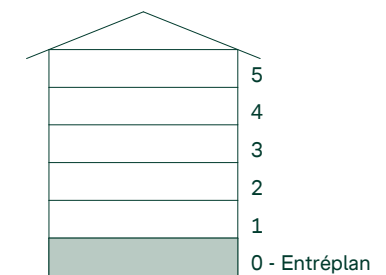
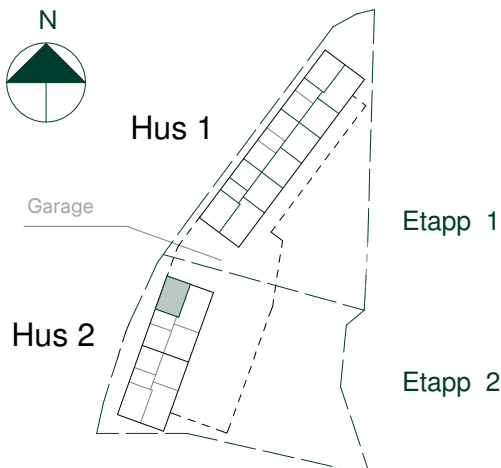
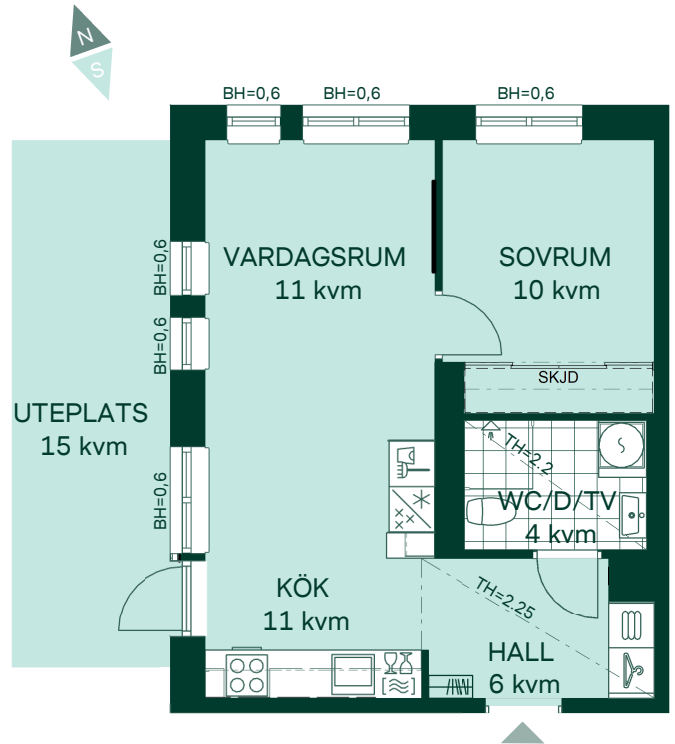

SKALA 1:100



Reservation för eventuella ändringar och ytvavikelser.
Datum: 2021-05-18