

Logementet i Kviberg

65 kvm











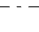

3 rum och kök

Hus: 2

Lgh: 22-1103, 22-1203, 22-1303, 22-1403

Upplåtelseform: Bostadsrätt

Våning: 1, 2, 3, 4

-  Diskmaskin
-  Häll med inbyggnadsugn
-  Frys
-  Kylskåp
-  Förberett för mikrovågsugn
-  Överskåp
-  Duschvägg
-  Kombimaskin
-  Linnedel
-  Städskåp
-  Elcentral
-  Radiator
-  Hatthylla
- TH — Takhöjd vid inklädnad/lokal försänkning, anges i meter
- BH Bröstningshöjd, anges i meter
- SKJD Skjutdörsgarderob

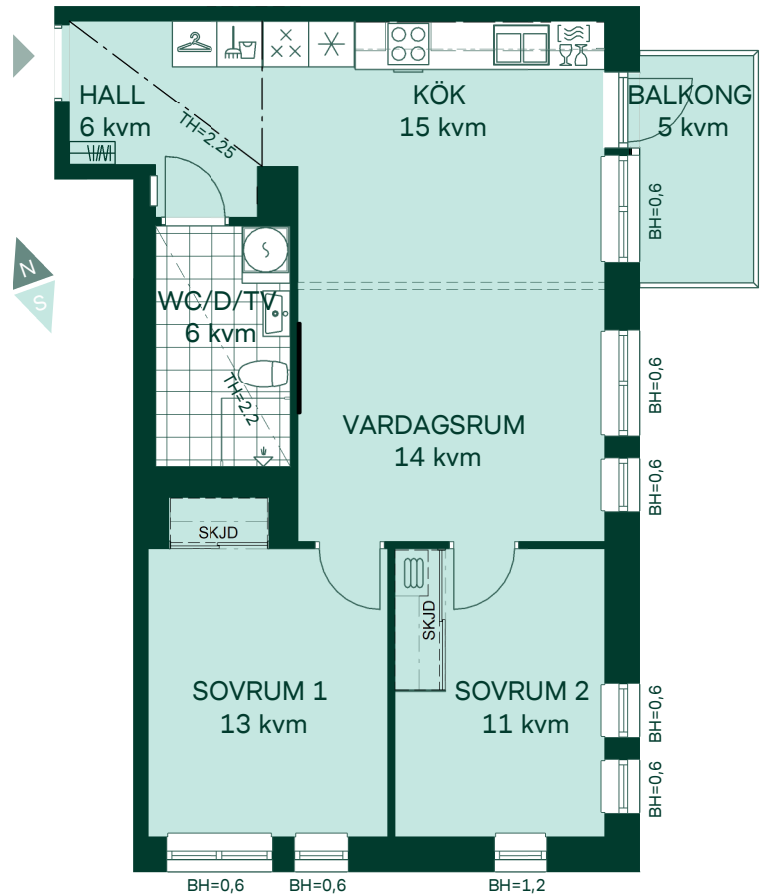

Takhöjd 2,5m om inget annat anges.
Mått anges i meter.
Kvadratmeter är cirka.
All inredning monteras enligt planritning.

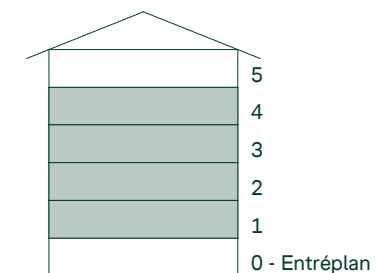
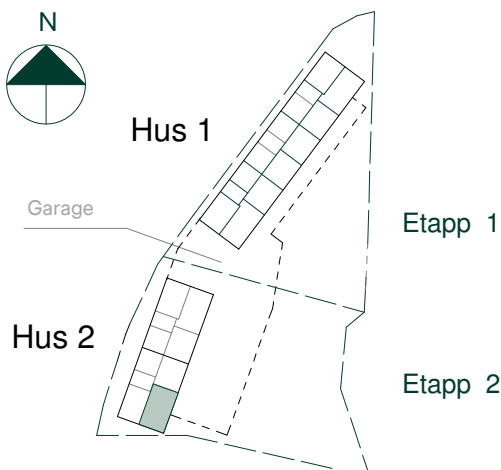

SKALA 1:100



Reservation för eventuella ändringar och ytväikelser.
Datum: 2021-05-18