

















# Fläderstråket II i Kareby Äng

121 kvm  
5 rum och kök

Hus: 301, 304, 307, 310, 313  
Upplåtelseform: Äganderätt

- |  |                            |     |                           |
|--|----------------------------|-----|---------------------------|
|    | Diskmaskin                 | BH  | Bröstningshöjd, anges i m |
|    | Inbyggnadshäll             | KLK | Klädkammare               |
|    | Frys                       | MM  | Mediacentral              |
|    | Kylskåp                    | TH  | Takhöjd, anges i m        |
|    | Högskåp med ugn            | VH  | Vägghöjd, anges i m       |
|    | Torktumlare                | VL  | Vindslucka                |
|    | Tvättmaskin                | VP  | Värmepump                 |
|    | Klädförvaring              |     |                           |
|    | Städskap                   |     |                           |
|    | Elcentral                  |     |                           |
|    | Golvvärmefördelare         |     |                           |
|    | Vattenmätare               |     |                           |
|  | Kapphylla                  |     |                           |
|  | Förberett för handdukstork |     |                           |
|  | Tillvalsvägg               |     |                           |
|  | Radiator                   |     |                           |

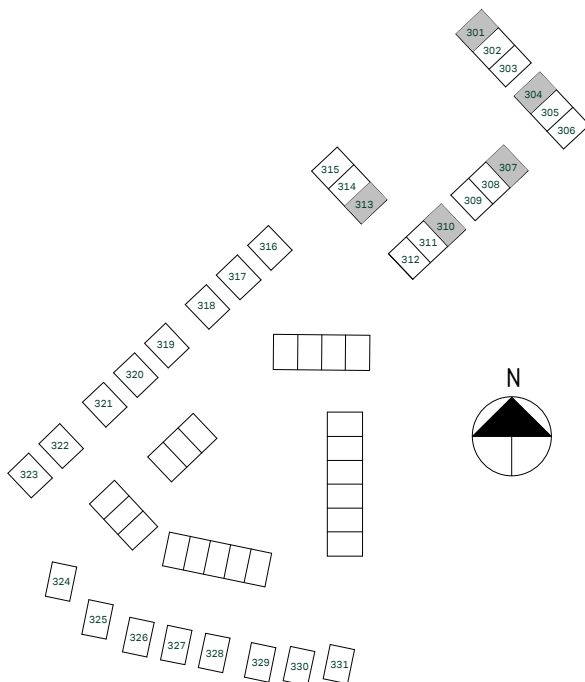
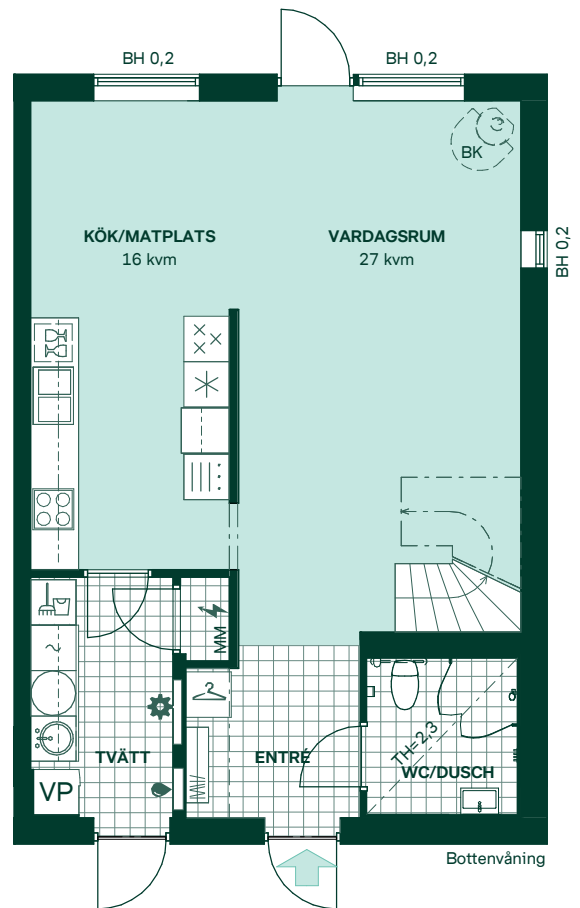
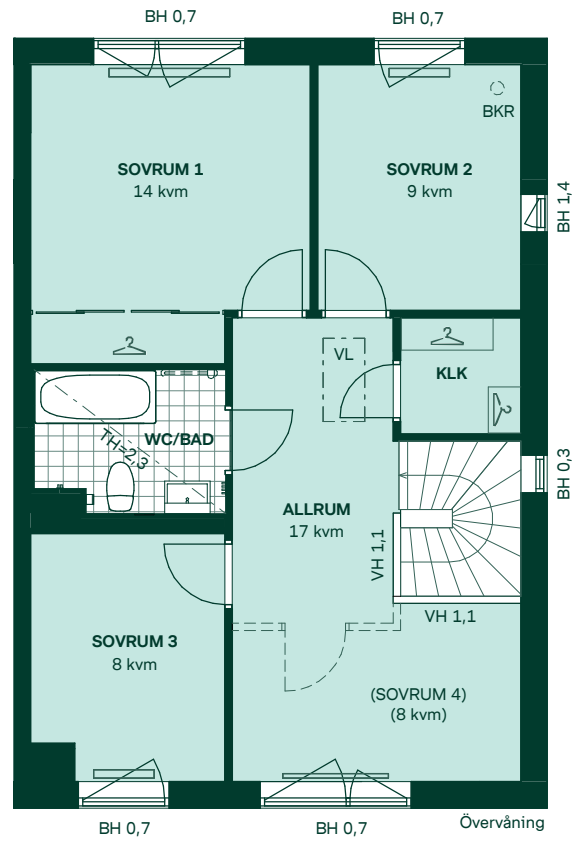

Avvikelser kan förekomma då vi kommer anpassa oss till höjderna i området.

Tomten sluttar från huset för erforderlig vattenavrinning.

SKALA 1:100

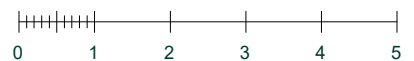

Reservation för eventuella ändringar och ytavvikelser.  
Datum: 2021-04-22