















Torparlyckan II i Steninge slottsby

101 kvm
4 rum och kök

Hus: 216, 220, 233, 236
Upplåtelseform: Bostadsrätt

- | | | | |
|---|----------------------------|-----|---------------------------|
|  | Diskmaskin | BH | Bröstningshöjd, anges i m |
|  | Inbyggnadshäll och ugn | KLK | Klädkammare |
|  | Frys | MM | Mediacentral |
|  | Kylskåp | TH | Takhöjd, anges i m |
|  | Torktumlare | VH | Vägghöjd, anges i m |
|  | Tvättmaskin | VL | Vindslucka |
|  | Klädförvaring | VP | Värmepump |
|  | Städskap | | |
|  | Linneskåp | | |
|  | Elcentral | | |
|  | Golvvärmefördelare | | |
|  | Vattenmätare | | |
|  | Förberett för handdukstork | | |
|  | Radiator | | |

Kvadratmeter är cirka.
Mått anges i meter.

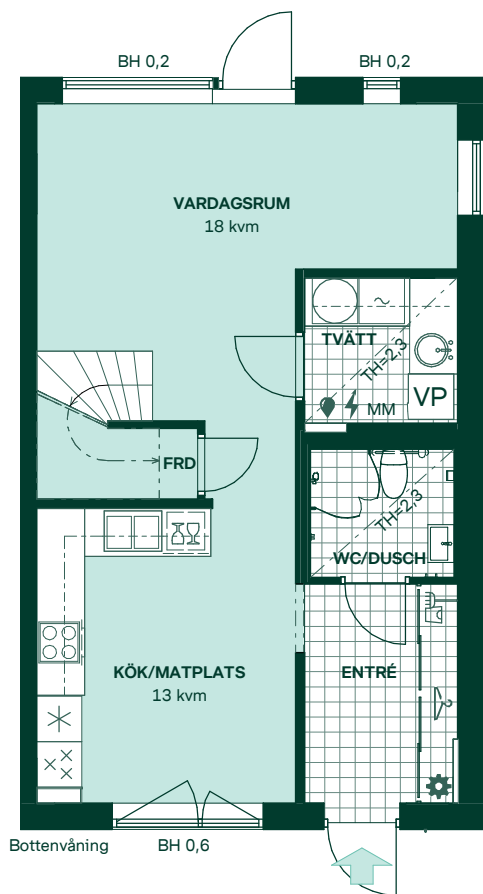
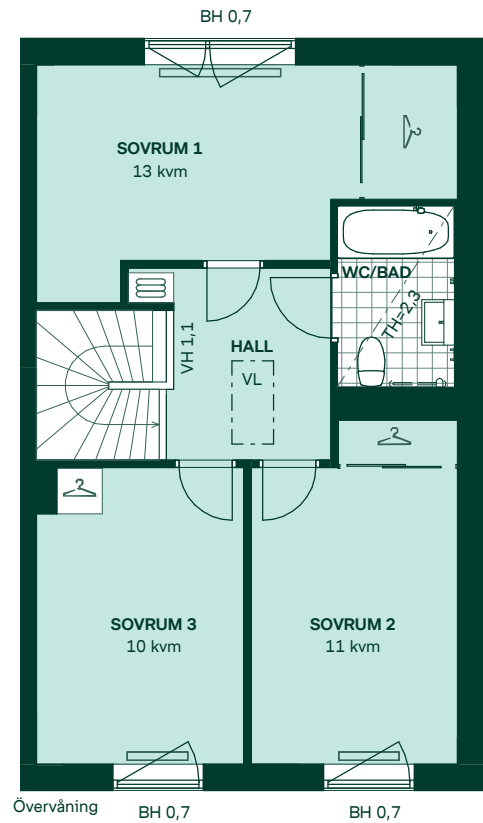
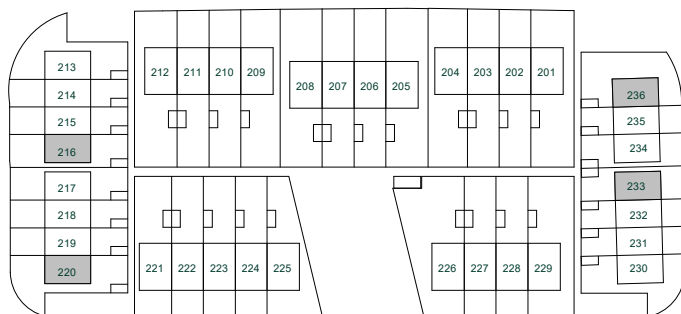

SKALA 1:100

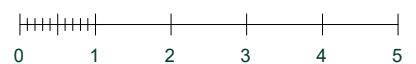

Reservation för eventuella ändringar och ytavvikelser.
Datum: 2021-02-01