

# Kryddan I i Södra Ekkällan

106 kvm

















4 rum och kök

Trapphus: 1

Lgh: 1:1003

Upplåtelseform: Bostadsrätt

Våning: E&2

-  Diskmaskin
-  Inbyggnadshäll i glaskeramik
-  Frys
-  Kylskåp
-  Högskaap med ugn / förberett för mikro
-  Överskaap i kök  
Tillval av överskaap i badrum
-  Duschvägg
-  Kombimaskin
-  Tvättpelare
-  Klädförvaring
-  Linneskaap eller linneskaapsinredning
-  Städskåp eller städskåpsinredning
-  Elcentral
- MEDIA** Mediauttag
-  Radiator
-  Förberett för handdukstork
-  Kapphylla
- SKJD. Skjutdörrsgarderob
- BH Bröstningshöjd fönster

Mått anges i meter.  
Kvadratmeter är cirka.  
Takhöjd 2,7 m på entréplan och 2,5 m på övervåning.  
All inredning monteras enligt planritning.

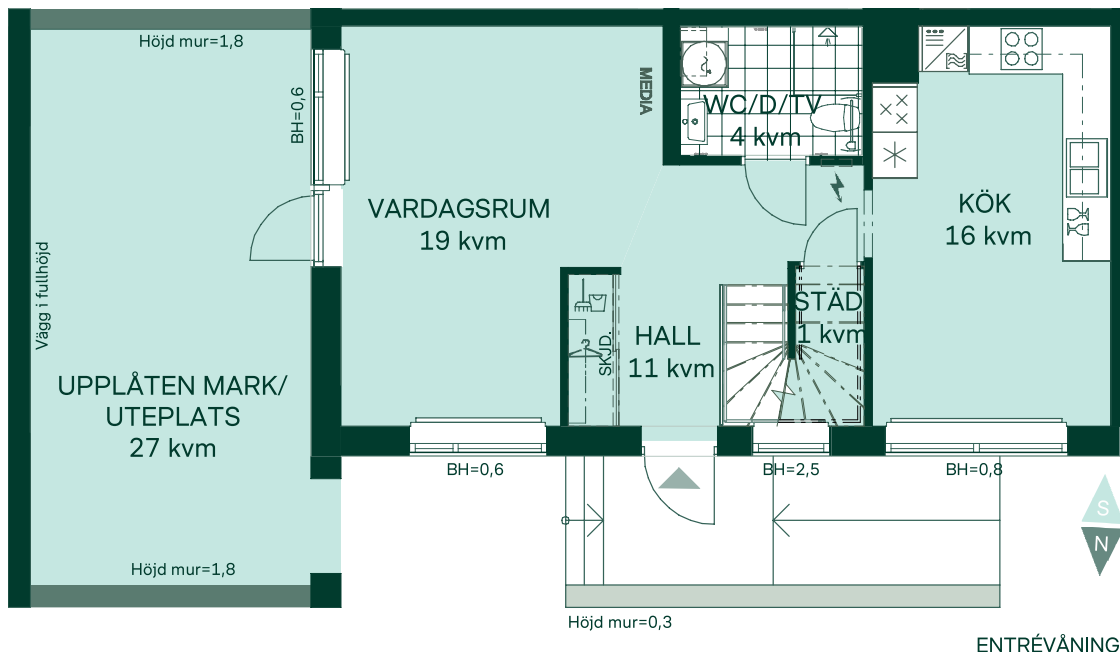

ENTRÉVÅNING

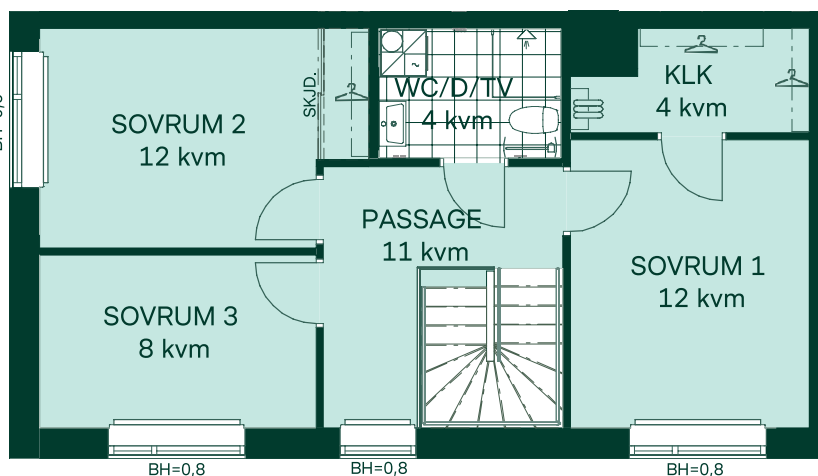

ÖVERVÅNING

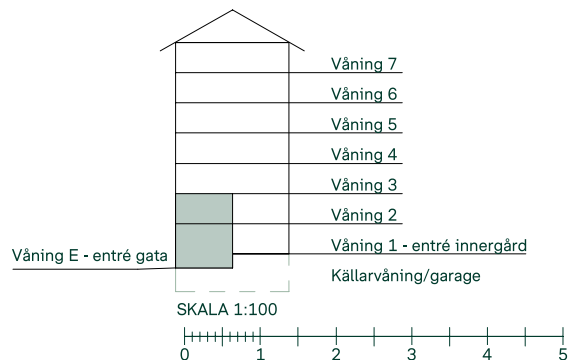
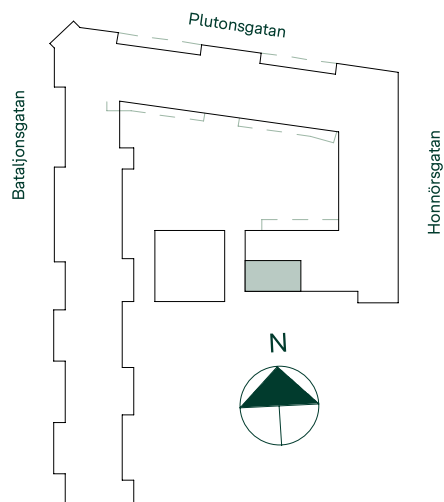

Reservation för eventuella ändringar och ytavvikelser.  
Datum: 2022-02-14