

# Glöd på Tomtebo gård

92 kvm

















4 rum och kök

Hus: 1

Lgh: 1B-1102, 1202, 1302, 1402

Upplåtelseform: Bostadsrätt

Plan: 11, 12, 13, 14

-  Diskmaskin
-  Inbyggnadshäll
-  Frys
-  Kylskåp
-  Högsåp med ugn / förberett för mikro
-  Överskåp
-  Duschvägg
-  Torktumlare
-  Tvättmaskin
-  Klädförvaring
-  Linneskåp
-  Städsåp
-  Elcentral
-  Förberett för handdukstork
-  Radiator
-  Hatthylla
- BH** Bröstningshöjd
- SKJD** Skjutdörrsgarderob
- IL** Inspektionslucka

Takhöjd 2,5 m om inget annat anges.

Kvadratmeter är cirka.

Mått anges i meter.

Lokala försänkningar i innertak kan förekomma.

Separat lägenhetsförråd om ca 2-5 kvm.

All inredning monteras enligt planritning.

--- Gräns för upplåten mark.

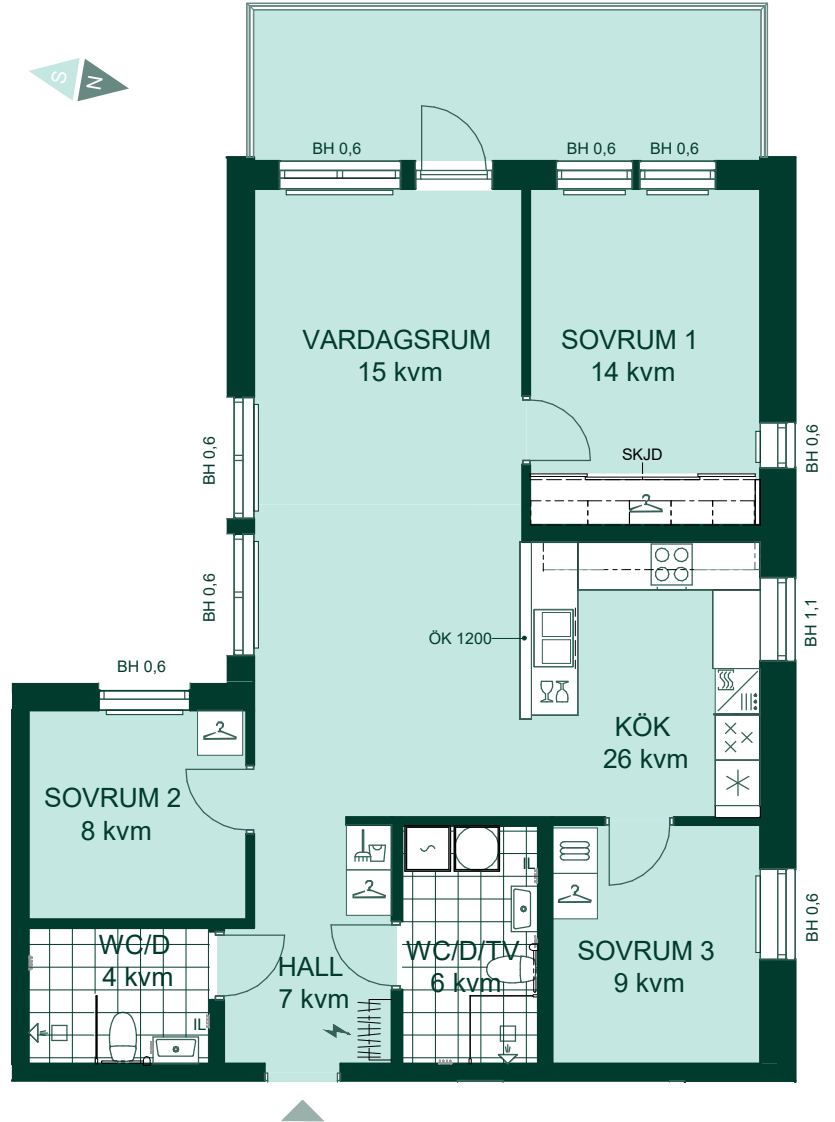

Hus 1



Hus 2

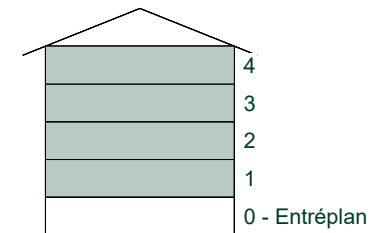
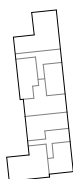

SKALA 1:100



Reservation för eventuella ändringar och ytavvikelser.  
Datum: 2024-01-18