

# Glöd på Tomtebo gård

90 kvm

















3 rum och kök

Hus: 1

Lgh: 1A-1103, 1203, 1303, 1403

Upplåtelseform: Bostadsrätt

Plan: 1, 2, 3, 4

-  Diskmaskin
-  Inbyggnadshäll
-  Frys
-  Kylskåp
-  Högskåp med ugn / förberett för mikro
-  Överskåp
-  Duschvägg
-  Torktumlare
-  Tvättmaskin
-  Klädförvaring
-  Linneskåp
-  Städskåp
-  Elcentral
-  Förberett för handdukstork
-  Radiator
-  Hatthylla
- BH** Bröstningshöjd
- SKJD** Skjutdörrsgarderob
- IL** Inspektionslucka

Takhöjd 2,5 m om inget annat anges.

Kvadratmeter är cirka.

Mått anges i meter.

Lokala försänkningar i innertak kan förekomma.

Separat lägenhetsförråd om ca 2-5 kvm.

All inredning monteras enligt planritning.

--- Gräns för upplåten mark.

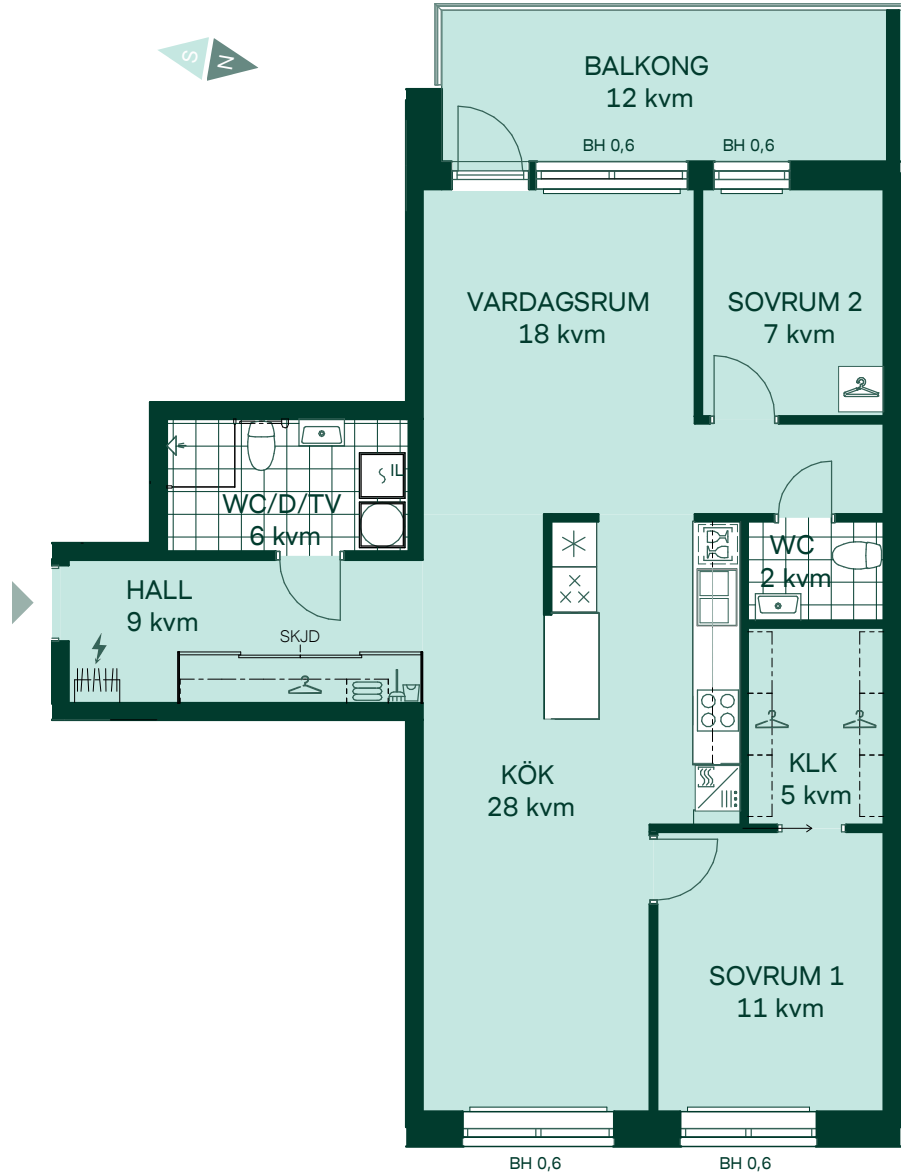

Hus 1

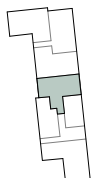

Hus 2

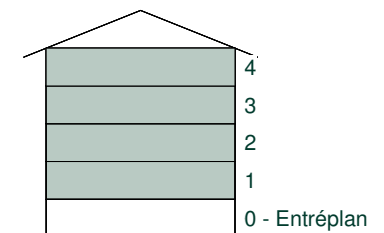

SKALA 1:100



Reservation för eventuella ändringar och ytavvikelser.  
Datum: 06/27/22 Revideringsdatum: 03/20/24