





















# Glimmer i Tollare

89 kvm

4 rum och kök

Hus: 3  
Lgh: 31204, 31304, 31404.  
Upplåtelseform: Bostadsrätt  
Våning: 2, 3, 4

-  Diskmaskin
-  Induktionshäll
-  Frys
-  Kylskåp
-  Högsåp med ugn/mikro /förberett för vinkyl
-  Översåp i kök  
Översåp i badrum (tillval)
-  Duschvägg, raka svängbara skårmar
-  Duschvägg, vikbara skårmar
-  Torktumlare
-  Tvättmaskin
-  Handduktork (tillval)
-  Högsåp (tillval)
-  Kommod (tillval storlek)
-  Klädförvaring
-  Linneförvaring
-  Städskåp
-  El- och mediacentral
-  Radiator
-  UT Undertakshöjd
-  BH Bröstningshöjd

Bröstningshöjd 0,7m om inget annat anges.  
Takhöjd 2,5m om inget annat anges.  
Kvadratmeter är cirka.  
Mått anges i meter.  
Lokala försänkningar i innertak kan förekomma.  
All fast inredning monteras enligt planritning.

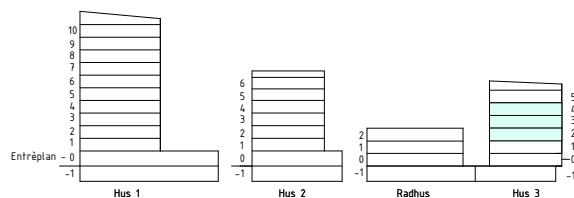
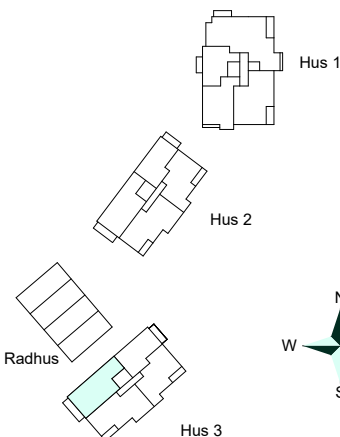
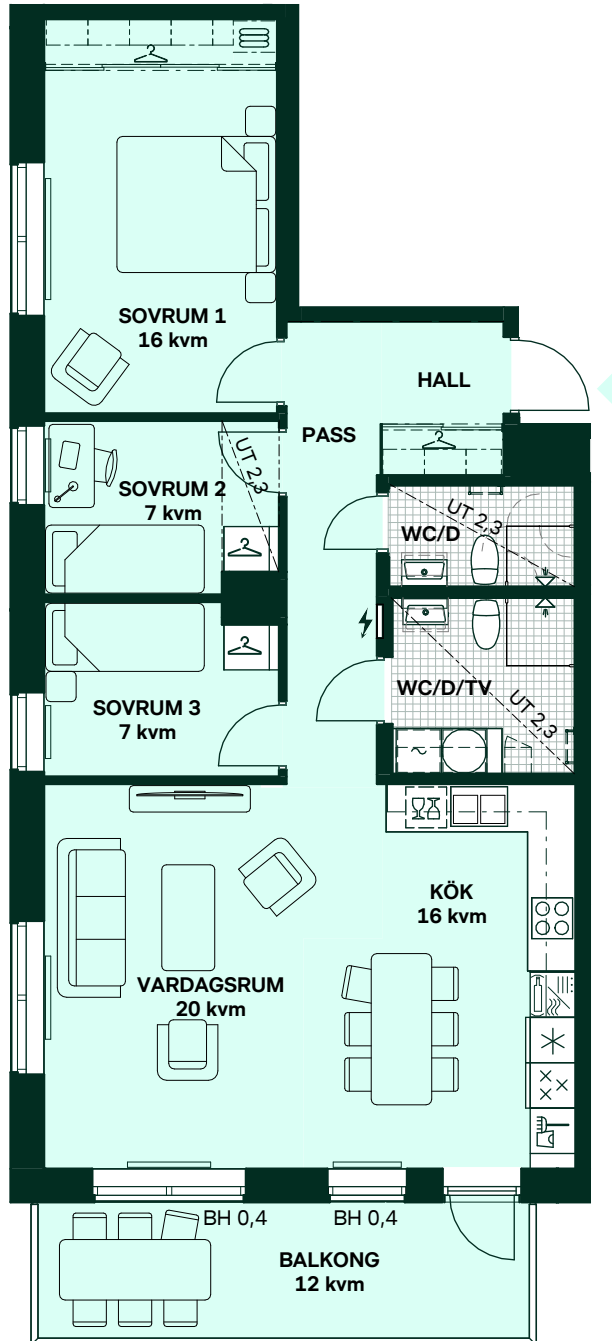

SKALA 1:100



Reservation för eventuella ändringar och ytavvikelser.  
Datum: 2025-10-03 Revidering datum: 2026-06-04